STATUTORY INSTRUMENTS

2000 No. 2707

HIGHWAYS, ENGLAND AND WALES

**The Essex County Council (Mayrose Bridge)
Scheme 1999 Confirmation Instrument 2000**

Made - - - - 28th September 2000

Coming into force in accordance with article 1

The Secretary of State for the Environment, Transport and the Regions makes this Instrument in exercise of powers conferred by section 106(3) of the Highways Act 1980(1) and now vested in him(2) and of all other powers enabling him in that behalf:

1. This Instrument may be cited as “The Essex County Council (Mayrose Bridge) Scheme 1999 Confirmation Instrument 2000” and shall come into force on the date on which notice that it has been confirmed is first published in accordance with paragraph 1 of Schedule 2 to the Highways Act 1980.

2. The Essex County Council (Mayrose Bridge) Scheme 1999 (“the Scheme”) is hereby confirmed without modifications.

3. The Scheme as confirmed is set out in the Schedule hereto (including the plan) and copies of the Scheme with its accompanying plan are deposited at the offices of the Department of the Environment, Transport and the Regions, Great Minster House, 76 Marsham Street, London SW1P 4DR, and at the offices of the Council of The Essex County Council at The Corporate Information Unit, ‘E’ Block, County Hall, Chelmsford.

Signed by authority of the Secretary of State for the Environment, Transport and the Regions

28th September 2000

R. C. Dobbie
Regional Director, Government Office for the
North East

(1) 1980 c. 66.
(2) S.I.1981/238.

Status: This is the original version (as it was originally made). This item of legislation is currently only available in its original format.

THE SCHEDULE

HIGHWAYS ACT 1980 THE ESSEX COUNTY COUNCIL (MAYROSE BRIDGE) SCHEME 1999

The Essex County Council (hereinafter referred to as “the Council”) makes this Scheme in exercise of their powers under section 106(3) of the Highways Act 1980 and of all other powers enabling them in that behalf:—

1. The Council are authorised to construct over the navigable waters of the River Crouch in the Parish of Rettendon in the Borough of Chelmsford and in the District of Basildon in the said County of Essex the bridge specified in the Schedule to this Scheme as part of the highway which they are proposing to construct between junctions with the A130 at the Rettendon Turnpike Roundabout and with the A130 to the south of the A127 Southend Arterial road.

2. This Scheme may be cited as the Essex County Council (Mayrose Bridge) Scheme 1999.

THE SCHEDULE TO THE SCHEME

PLANS AND SPECIFICATIONS OF MAYROSE BRIDGE

The Mayrose bridge structure spans the River Crouch approximately 325 metres south-west of the existing crossing of the A130 Battlesbridge Bypass.

The northern limit of the structure is 303 metres south west of the centre of the existing A130 bridge over the River Crouch. The southern limit is 341 metres south west of the centre of the existing A130 bridge over the River Crouch.

Ordnance Survey co-ordinates are:—

Northern limit of structure—E=577298	N=194051
Southern limit of structure—E=577303	N=193995

The substructure and deck are to be constructed of reinforced concrete, pre-stressed concrete or steel composite with metal parapets as shown on drawing no. 0113/SK 655C.

The bridge will be built in accordance with the “Specification for Highway Works” published by The Stationery Office.

The bridge is to be 22.3 metres wide overall carrying two 7.9 metre wide carriageways including 0.3 metre wide marginal strips to either side. It will be at a small skew to the River with two supporting piers positioned so as not to obstruct the main watercourse. The total span length is to be 36.4 metres and the headway over the river is to be 3 metres above normal high tide level.

Status: This is the original version (as it was originally made). This item of legislation is currently only available in its original format.

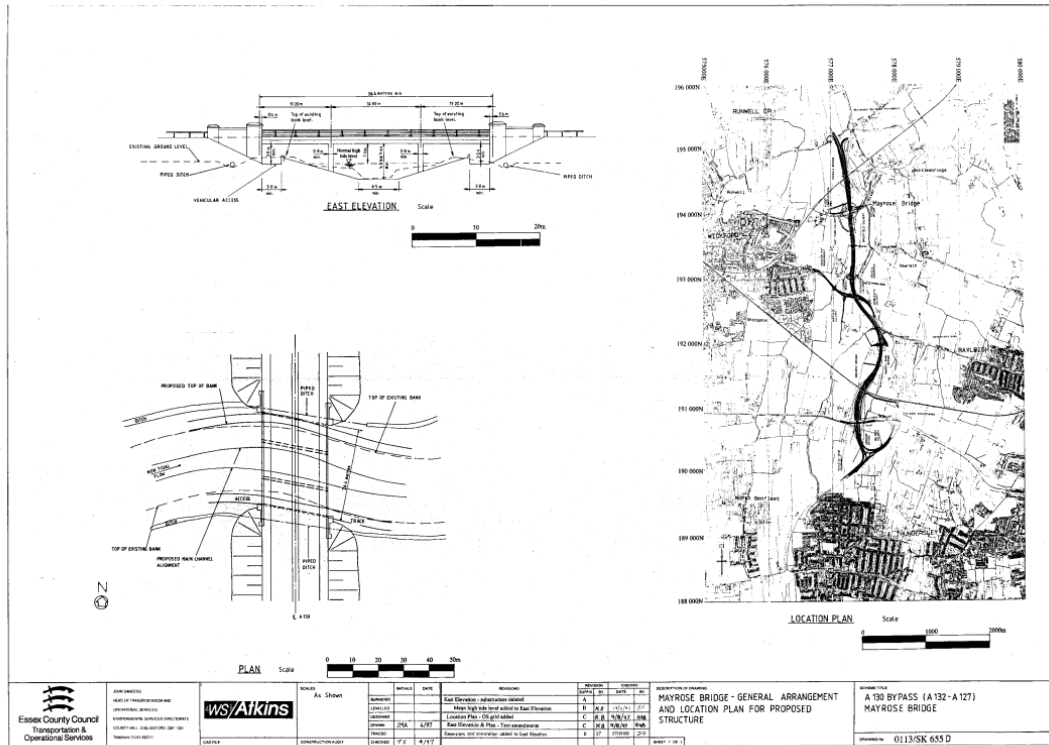

Given under the common seal of the Council this Twenty Second day of April One thousand nine hundred and ninety nine. The COMMON SEAL of ESSEX COUNTY COUNCIL was hereto affixed in the presence of

L.S.

J. L. Moore
Attesting Officer