

**DEPARTMENT FOR INFRASTRUCTURE**

Map No. IN1/21/633780 referred to in "The Private Access on the A6 Toome By-Pass (Stopping-Up) Order (Northern Ireland) 2022" made by the Department on 25th October 2022 and coming into operation on 16th November 2022.

©Based upon the Ordnance Survey map with the Permission of the Director and the Chief Executive.

Crown Copyright

SCALE 1:2000 @ A3

**MAP 1**

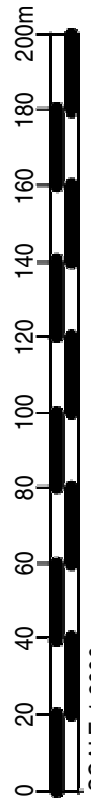
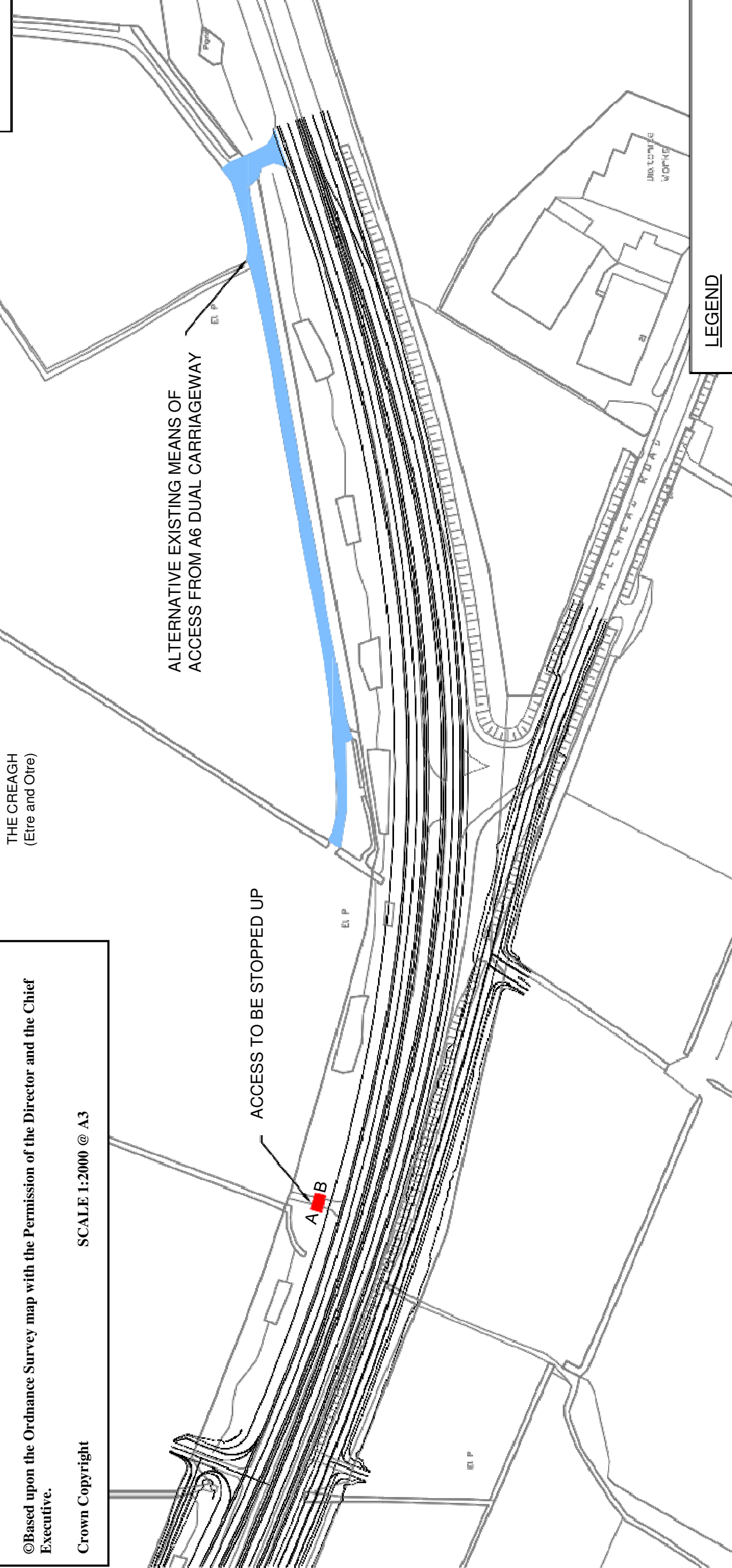
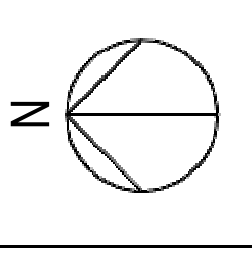

**LEGEND**

- A PRIVATE ACCESS STOPPED UP
- B PRIVATE ACCESS STOPPED UP
- TOWNLAND BOUNDARY

Project Title  
**A6 RANDALSTOWN CASTLEDAWSON**

Client  
**Infrastructure Donegal**

Drawing Title  
**THE PRIVATE ACCESSES (A6 CASTLEDAWSON BY-PASS) (STOPPING UP) ORDER (NORTHERN IRELAND) 2020**

FOR INFORMATION			
Designed	Drawn	Checked	Approved
60571704	JC	JM	JM
Purpose of Issue		Date	
AECOM Internal Project No.		07/01/21	
60571704		Fit for Information	
Scale @ A3		Zone / Mileage	
1:2000			

THIS DOCUMENT HAS BEEN PREPARED PURSUANT TO AND SUBJECT TO THE TERMS OF AECOM'S APPOINTMENT BY ITS CLIENT. AECOM ACCEPTS NO LIABILITY FOR ANY USE OF THIS DOCUMENT OTHER THAN BY ITS ORIGINAL CLIENT OR FOLLOWING AECOM'S EXPRESS AGREEMENT TO SUCH USE. AND ONLY FOR THE PURPOSES FOR WHICH IT WAS PREPARED AND PROVIDED.	
Drawing Number	Rev
<b>TML A6R21-21-0000-02-0000</b>	<b>P02</b>

AECOM Infrastructure & Environment UK Ltd  
 AECOM, The Clarence West Building  
 2 Clarence Street West  
 Belfast  
 Tel: +44 28 90607200  
 Fax: +44 28 90607399  
 www.aecom.com

**AECOM**