

Draft Order laid before Parliament under paragraph 3(9) of Schedule 1 to the Scotland Act 1998, for approval by resolution of each House of Parliament.

DRAFT STATUTORY INSTRUMENTS

2014 No. (S.)

CONSTITUTIONAL LAW
DEVOLUTION, SCOTLAND

**The Scottish Parliament (Constituencies and Regions) Order
2014**

Made - - - - - []

Coming into force in accordance with article 1(2) and (3)

At the Court at Buckingham Palace, the day of

Present,

The Queen's Most Excellent Majesty in Council

In accordance with paragraph 3(6) of Schedule 1 to the Scotland Act 1998(a), the Boundary Commission for Scotland submitted to the Secretary of State a report dated October 2013 relating to the boundaries at Princes Gate and Greenacres by Robroyston.

In accordance with paragraph 3(9) of that Schedule a copy of that report and a draft of this Order in Council to give effect to the recommendations contained in the report were laid before Parliament by the Secretary of State.

In accordance with paragraph 6(2) of that Schedule the draft was approved by a resolution of each House of Parliament.

Accordingly, Her Majesty, in exercise of the powers conferred upon Her by paragraph 6(1) and (5) of that Schedule, is pleased, by and with the advice of Her Privy Council, to order as follows:

Citation, commencement and interpretation

1.—(1) This Order may be cited as the Scottish Parliament (Constituencies and Regions) Order 2014.

(a) 1998 c.46. Schedule 1 was substituted by the Scottish Parliament (Constituencies) Act 2004 (c.13) and amended by the Scotland Act 2012 (c.11).

(2) Except for article 4, this Order comes into force on the day after the day on which it is made(a).

(3) Article 4 comes into force on the dissolution of the Parliament.

(4) In this Order “the Act” means the Scotland Act 1998.

Constituencies

2.—(1) For the purposes of paragraph 1(2)(c) of Schedule 1 to the Act, the constituencies provided for are those which—

- (a) are named in column 1 of the table in Schedule 1 to this Order; and
- (b) comprise the areas described for each such constituency in the deposited data.

(2) In paragraph (1)(b) the “deposited data” means the data recorded on the DVD-ROMs—

- (a) entitled “Interim Review of Scottish Parliament Boundaries at Princes Gate and Greenacres by Robroyston – master copy submitted to the Secretary of State for Scotland”;
- (b) etched with the seal of the Boundary Commission for Scotland and the signatures of its deputy Chairman and Secretary;
- (c) submitted to the Secretary of State for Scotland on 31 October 2013; and
- (d) deposited with him at his offices at 1 Melville Crescent, Edinburgh, EH3 7HW.

(3) The constituencies are designated as being either county constituencies or burgh constituencies according to the entry in column 2 of Schedule 1 opposite each constituency name.

Regions

3. For the purposes of paragraph 2(2) of Schedule 1 to the Act, the regions provided for are those which—

- (a) are named in column 1 of the table in Schedule 2 to this Order; and
- (b) comprise the combined areas of the constituencies mentioned in column 2 of that table opposite the name of each region.

Revocation

4. The Scottish Parliament (Constituencies and Regions) Order 2010(b) is revoked.

Richard Tilbrook
Clerk of the Privy Council

(a) By virtue of 6(7) of Schedule 1 to the Scotland Act 1998 the coming into force of this Order does not affect the return of any member to the Scottish Parliament or its constitution until the Scottish Parliament is dissolved.

(b) S.I. 2010/2691. Article 3 of S.I. 2010/2691 amended paragraphs 1(2)(c) and 2(2) of Schedule 1 to the Scotland Act 1998. These paragraphs were amended by paragraphs 8 and 9 of Schedule 1 to the Scotland Act 2012 (c.11).

SCHEDULE 1

Article 2

Scottish Parliament Constituencies

(other than Orkney Islands and Shetland Islands Constituencies)

<i>Column 1</i>	<i>Column 2</i>
<i>Constituency Name</i>	<i>Designation</i>
Aberdeen Central	Burgh
Aberdeen Donside	Burgh
Aberdeen South and North Kincardine	County
Aberdeenshire East	County
Aberdeenshire West	County
Airdrie and Shotts	Burgh
Almond Valley	County
Angus North and Mearns	County
Angus South	County
Argyll and Bute	County
Ayr	Burgh
Banffshire and Buchan Coast	County
Caithness, Sutherland and Ross	County
Carrick, Cumnock and Doon Valley	County
Clackmannanshire and Dunblane	County
Clydebank and Milngavie	County
Clydesdale	County
Coatbridge and Chryston	Burgh
Cowdenbeath	County
Cumbernauld and Kilsyth	County
Cunninghame North	County
Cunninghame South	County
Dumbarton	County
Dumfriesshire	County
Dundee City East	Burgh
Dundee City West	Burgh
Dunfermline	County
East Kilbride	Burgh
East Lothian	County
Eastwood	County
Edinburgh Central	Burgh
Edinburgh Eastern	Burgh
Edinburgh Northern and Leith	Burgh
Edinburgh Pentlands	Burgh
Edinburgh Southern	Burgh
Edinburgh Western	Burgh
Na h-Eileanan an Iar	County
Etrick, Roxburgh and Berwickshire	County
Falkirk East	County
Falkirk West	County
Galloway and West Dumfries	County
Glasgow Anniesland	Burgh
Glasgow Cathcart	Burgh
Glasgow Kelvin	Burgh

<i>Column 1</i>	<i>Column 2</i>
<i>Constituency Name</i>	<i>Designation</i>
Glasgow Maryhill and Springburn	Burgh
Glasgow Pollok	Burgh
Glasgow Provan	Burgh
Glasgow Shettleston	Burgh
Glasgow Southside	Burgh
Greenock and Inverclyde	County
Hamilton, Larkhall and Stonehouse	Burgh
Inverness and Nairn	County
Kilmarnock and Irvine Valley	County
Kirkcaldy	County
Linlithgow	County
Mid Fife and Glenrothes	County
Midlothian North and Musselburgh	County
Midlothian South, Tweeddale and Lauderdale	County
Moray	County
Motherwell and Wishaw	Burgh
North East Fife	County
Paisley	Burgh
Perthshire North	County
Perthshire South and Kinross-shire	County
Renfrewshire North and West	County
Renfrewshire South	County
Rutherglen	Burgh
Skye, Lochaber and Badenoch	County
Stirling	County
Strathkelvin and Bearsden	County
Uddingston and Bellshill	Burgh

SCHEDULE 2

Article 3

Scottish Parliament Regions

<i>Column 1</i> <i>Region</i>	<i>Column 2</i> <i>Constituency Name</i>
Central Scotland	Airdrie and Shotts Coatbridge and Chryston Cumbernauld and Kilsyth East Kilbride Falkirk East Falkirk West Hamilton, Larkhall and Stonehouse Motherwell and Wishaw Uddingston and Bellshill
Glasgow	Glasgow Anniesland Glasgow Cathcart Glasgow Kelvin Glasgow Maryhill and Springburn Glasgow Pollok Glasgow Provan Glasgow Shettleston Glasgow Southside Rutherglen
Highlands and Islands	Argyll and Bute Caithness, Sutherland and Ross Na h-Eileanan an Iar Inverness and Nairn Moray Orkney Islands Shetland Islands Skye, Lochaber and Badenoch
Lothian	Almond Valley Edinburgh Central Edinburgh Eastern Edinburgh Northern and Leith Edinburgh Pentlands Edinburgh Southern Edinburgh Western Linlithgow Midlothian North and Musselburgh
Mid Scotland and Fife	Clackmannanshire and Dunblane Cowdenbeath Dunfermline Kirkcaldy Mid Fife and Glenrothes North East Fife

<i>Column 1</i>	<i>Column 2</i>
<i>Region</i>	<i>Constituency Name</i>
	Perthshire North Perthshire South and Kinross-shire Stirling
North East Scotland	Aberdeen Central Aberdeen Donside Aberdeen South and North Kincardine Aberdeenshire East Aberdeenshire West Angus North and Mearns Angus South Banffshire and Buchan Coast Dundee City East Dundee City West
South Scotland	Ayr Carrick, Cumnock and Doon Valley Clydesdale Dumfriesshire East Lothian Ettrick, Roxburgh and Berwickshire Galloway and West Dumfries Kilmarnock and Irvine Valley Midlothian South, Tweeddale and Lauderdale
West Scotland	Clydebank and Milngavie Cunninghame North Cunninghame South Dumbarton Eastwood Greenock and Inverclyde Paisley Renfrewshire North and West Renfrewshire South Strathkelvin and Bearsden

EXPLANATORY NOTE

(This note is not part of the Order)

This Order gives effect to the recommendations contained in the Report on Interim Review of Scottish Parliament Boundaries at Princes Gate and Greenacres by Robroyston by the Boundary Commission for Scotland dated October 2013. The report is available on the Boundary Commission for Scotland's website (www.bcomm-scotland.gov.uk) or in hard copy from The Stationery Office (www.tso.co.uk Tel: 0870 600 5522).

The report recommends changes to the constituency boundaries between Glasgow Provan constituency and Strathkelvin and Bearsden constituency and the region boundaries between Glasgow region and West Scotland region as set out by the Scottish Parliament (Constituencies and Regions) Order 2010 (S.I. 2010/2691). An indicative map of the changes being made to these constituencies and regions is included in this note.

The Order defines the name, status and area of 71 of the 73 Scottish Parliament constituencies and the name and area of each Scottish Parliament region. (The Orkney Islands constituency and the Shetland Islands constituency are not included in the Order because Schedule 1 to the Scotland Act 1998 ("the 1998 Act") provides for them directly). Other than the changes made to the Glasgow Provan constituency and Strathkelvin and Bearsden constituency and the Glasgow region and West Scotland region, the constituencies and regions are the same as provided by the Scottish Parliament (Constituencies and Regions) Order 2010.

The Order comes into force on the day after it is made (with the exception of article 4). It does not affect the return of any member to the Parliament or its constitution until the Parliament is dissolved (paragraph 6(7) of Schedule 1 to the 1998 Act). It does apply to any proceedings which occur before dissolution but which relate to a poll which will take place after dissolution.

The 71 constituencies are named and defined by article 2 read together with Schedule 1. The area of each constituency is described in geographical information system data stored on a set of DVD-ROMs deposited with the Secretary of State for Scotland. The DVD-ROMs are entitled "Interim Review of Scottish Parliament Boundaries at Princes Gate and Greenacres by Robroyston" and set out the area of each constituency, taking account of the changes recommended by the Boundary Commission for Scotland. Maps of the boundaries are available on the Boundary Commission for Scotland's website and hard copies can be requested by writing to the Commission.

Each constituency is (by article 2(3) and Schedule 1) given the status of a burgh constituency or a county constituency. That status is relevant to the application of rules governing the conduct of elections to the Scottish Parliament (provided for under section 12 of the 1998 Act).

The regions are named and defined by article 3 read together with Schedule 2.

An impact assessment has not been produced for this instrument as no impact on business or the private or voluntary sector is foreseen.

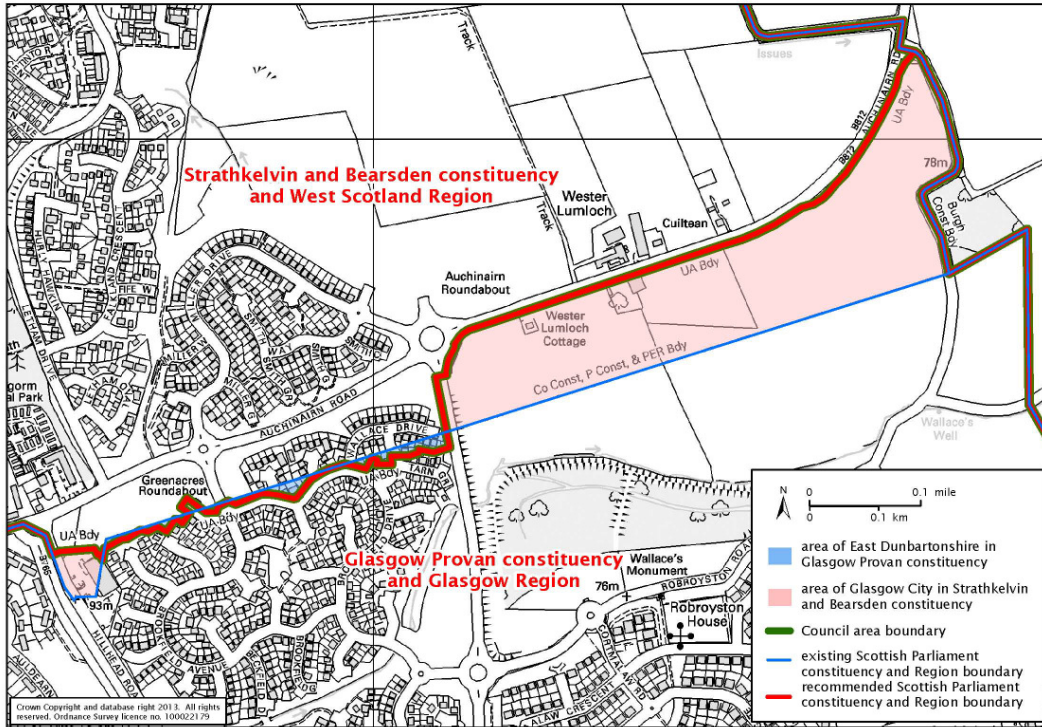

© Crown copyright 2013

Printed and published in the UK by The Stationery Office Limited under the authority and superintendence of Carol Tullo, Controller of Her Majesty's Stationery Office and Queen's Printer of Acts of Parliament.

£5.75

UK2013121610 12/2013 19585

<http://www.legislation.gov.uk/id/ukdsi/2014/9780111107478>

ISBN 978-0-11-110747-8



9 780111 107478