

*This Statutory Instrument has been printed in substitution of the SI of the same number and is being issued free of charge to all known recipients of that Statutory Instrument.*

---

STATUTORY INSTRUMENTS

---

**2011 No. 249**

**HIGHWAYS, ENGLAND**

**The Cobham Motorway Service Area Trunk  
Road (Connecting Roads) Order 2011**

*Made - - - - 8th February 2011*

*Coming into force - - 23rd February 2011*

The Secretary of State for Transport makes this Order in exercise of powers conferred by sections 10 and 41 of the Highways Act 1980<sup>(1)</sup> and now vested in him<sup>(2)</sup>:

1. This Order may be cited as the Cobham Motorway Services Area Trunk Road (Connecting Roads) Order 2011 and shall come into force on 23rd February 2011.

2. In this Order –

- (i) “the Motorway” means the M25 London Orbital Motorway;
- (ii) “the plan” means the plan numbered HA 10/MP/111 marked “The Cobham Motorway Services Area Trunk Road (Connecting Roads) Order 2011”, signed by authority of the Secretary of State for Transport and deposited at Document Deposit Service, Communities and Local Government, Floor 13 (IMD), Ashdown House, St Leonards on Sea, Hastings, East Sussex TN37 7GA; and
- (iii) “the slip roads” means the new highways which the Secretary of State proposes to construct along the routes described in the Schedule to this Order and which connect the Motorway with other proposed highways at the places stated in that Schedule.

3. The slip roads shall become trunk roads from the date when this Order comes into force.

4. The centre line of each of the trunk roads is indicated by a heavy black line on the plan.

---

(1) 1980 c 66  
(2) SI 1981/238, SI 1997/2971, SI 2002/2626, SI 2006/1926, SI 2008/1034

---

**Status:** This is the original version (as it was originally made). This item of legislation is currently only available in its original format.

---

Signed by authority of the Secretary of State for Transport

8th February 2011

*Peter Adams*  
A Divisional Director  
Highways Agency

**Status:** This is the original version (as it was originally made). This item of legislation is currently only available in its original format.

## THE SCHEDULE

### ROUTES OF THE SLIP ROADS

The routes of the slip roads are five routes to connect the clockwise and anti-clockwise carriageways of the Motorway with the access roads being provided to the Cobham Motorway Service Area at Downside near Cobham in the County of Surrey (the slip roads along these routes being respectively given the numbers 1, 2, 3, 4, and 5 on the plan).

**Status:** This is the original version (as it was originally made). This item of legislation is currently only available in its original format.

THE COBHAM MOTORWAY SERVICES AREA  
SLIP ROADS  
ORDER 2011

KEY:

CENTRE LINE OF THE SLIP ROADS 

OTHER PROPOSED HIGHWAYS 

SCALES:	SITE PLAN (1 No.)	1:2500
---------	-------------------	--------

PLANS REGISTRY	SIGNED BY AUTHORITY OF THE SECRETARY OF STATE FOR TRANSPORT ON THE 8th February 2011
FILE No. HA 10/MP/111	<i>Peter Adams</i> Divisional Director Major Projects Division Highways Agency

**Status:** This is the original version (as it was originally made). This item of legislation is currently only available in its original format.

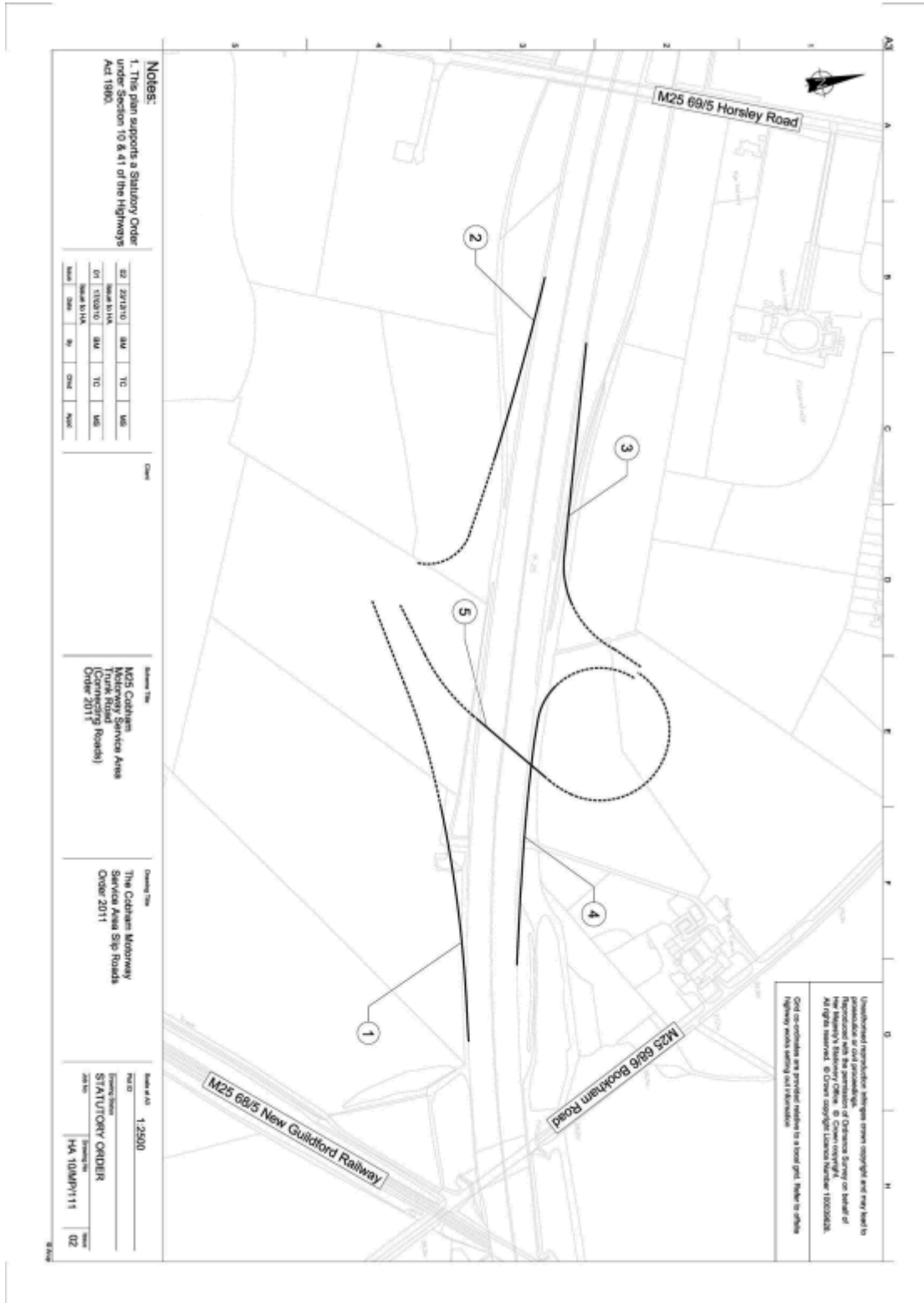

**Notes:**  
 1. This plan supports a Statutory Order under Section 10 & 41 of the Highways Act 1980.

RD	SR	TR	MS
DR	TR	MS	MS
DR	TR	MS	MS
DR	TR	MS	MS

**Related To:**  
 M25 Cobham Motorway Service Area (Cork Road Slip Roads) Order 2011

**Related To:**  
 The Cobham Motorway Service Area Slip Roads Order 2011

**Scale of OS:** 1:2500  
**Source:** STATUTORY ORDER  
**Reference:** HA 10(M)111  
**Date:** 02

This document is a reproduction of a document that has been reproduced with the permission of Ordnance Survey on behalf of Her Majesty's Stationery Office. © Crown Copyright. All rights reserved. © Crown Copyright Licence Number: 100026288.  
 OSF coordinates are provided relative to a local grid. Refer to other Ordnance Survey publications for details.

**Status:** This is the original version (as it was originally made). This item of legislation is currently only available in its original format.

---

### **EXPLANATORY NOTE**

This Order enables slip roads to be constructed to connect the M25 Motorway to the Cobham Motorway Service Area at downside near Cobham in the County of Surrey.