WELSH STATUTORY INSTRUMENTS

2010 No. 934 (W.96)

LOCAL GOVERNMENT, WALES

The County Borough of Caerphilly (Communities) Order 2010

Made - - - - - *12 March 2010*

Coming into force - - - - - *1 April 2010*

The Local Government Boundary Commission for Wales, have submitted to the Welsh Ministers, in accordance with sections 54(1) and 58(2) of the Local Government Act 1972(1), a report dated July 2009 on their review of, and proposals for, communities within part of the County Borough of Caerphilly.

The Welsh Ministers have decided to give effect to the Commission's proposals without modification.

More than six weeks have elapsed since those proposals were submitted to the Welsh Ministers.

The Welsh Ministers make the following Order in exercise of the powers conferred on the Secretary of State by section 58(2) of the Local Government Act 1972 and now vested in them so far as exercisable in relation to Wales(2):

Title and commencement

1.—(1) The title of this Order is The County Borough of Caerphilly (Communities) Order 2010.

(2) For any purpose set out in regulation 4(1) of the Regulations, this Order comes into operation on the day after that on which it is made.

(3) For all other purposes, this Order comes into force on 1 April 2010, which is the appointed day for the purposes of the Regulations.

Interpretation

2. In this Order—

“the Regulations” (“*y Rheoliadau*”) means the Local Government Area Changes Regulations 1976(3);

(1) 1972 c. 70.

(2) The powers of the Secretary of State were transferred to the National Assembly for Wales by the National Assembly for Wales (Transfer of Functions) Order 1999 (S.I.1999/672) and are now vested in the Welsh Ministers by virtue of paragraph 30 of Schedule 11 to the Government of Wales Act 2006 (c. 32).

(3) S.I. 1976/246 (as amended by various statutory instruments which amendments are not relevant to this statutory instrument).

“Map A” (“Map A”), “Map B” (“Map B”), “Map C” (“Map C”), “Map D” (“Map D”), “Map E” (“Map E”), “Map F” (“Map F”), “Map G” (“Map G”), “Map H” (“Map H”), “Map I” (“Map I”), “Map J” (“Map J”), “Map K” (“Map K”), “Map L” (“Map L”), “Map M” (“Map M”) and “Map N” (“Map N”) mean respectively the maps marked A, B, C, D, E, F, G, H, I, J, K, L, M and N of the County Borough of Caerphilly (Communities) Order 2010, deposited in accordance with regulation 5 of the Regulations; and

where a boundary is shown on a map as running along a road, railway line, footway, watercourse or similar geographical feature, it is to be treated as running along the centre line of the feature.

3. Changes are made in the local government area of the County Borough of Caerphilly in accordance with the following provisions of this Order.

Caerphilly and Penyrheol Trecenydd and Energlyn – change in community areas and ward boundaries and consequential changes to electoral arrangements

4. The part of the community of Caerphilly shown hatched on Map A—
 - (a) is transferred to the community of Penyrheol Trecenydd and Energlyn;
 - (b) forms part of the Trecenydd ward of the community of Penyrheol Trecenydd and Energlyn; and
 - (c) forms part of the electoral division of Penyrheol.
5. The part of the community of Penyrheol Trecenydd and Energlyn shown hatched on Map B—
 - (a) is transferred to the community of Caerphilly;
 - (b) forms part of the Cwrt Rawlins ward of the community of Caerphilly; and
 - (c) forms part of the electoral division of St. Martins.

6. The part of the community of Caerphilly shown hatched on Map C now forms the Cwrt Rawlins ward and the Watford ward is altered to be in alignment with the new community ward boundary.

7. In the community of Caerphilly the number of councillors to be elected for the ward of Castle is 2, the ward of Cwrt Rawlins is 2 and for the ward of Watford is 1.

8. In the community of Penyrheol Trecenydd and Energlyn the number of councillors to be elected for the Penyrheol ward is 4.

Caerphilly and Van – change in community areas and ward boundaries and consequential changes to electoral arrangements

9. The part of the community of Van shown hatched on Map D—
 - (a) is transferred to the community of Caerphilly;
 - (b) forms part of the Tonyfelin ward; and
 - (c) forms part of the electoral division of Morgan Jones.
10. The part of the community of Caerphilly shown cross hatched on Map D—
 - (a) is transferred from the Twyn ward; and
 - (b) forms part of the Tonyfelin ward.

Penyrheol Trecenydd and Energlyn and Llanbradach and Pwll-y-Pant – change in community areas and ward boundaries and consequential changes to electoral arrangements

11. The part of the community of Llanbradach and Pwll-y-Pant shown hatched on Map E—

- (a) is transferred to the community of Penyrheol Trecenydd and Energlyn;
- (b) forms part of the Energlyn ward; and
- (c) forms part of the electoral division of Penyrheol.

12. The part of the community of Penyrheol Trecenydd and Energlyn shown hatched on Map F—

- (a) is transferred from the Trecenydd ward; and
- (b) forms part of the Energlyn ward.

Llanbradach and Pwll-y-Pant and Caerphilly – change in community areas and consequential changes to electoral arrangements

13. The part of the community of Caerphilly shown hatched on Map G—

- (a) is transferred to the community of Llanbradach and Pwll-y-pant;
- (b) forms part of the Pwll-y-Pant ward; and
- (c) forms part of the electoral division of Llanbradach.

Maesycwmmmer and Pengam – change in community areas and consequential changes to electoral arrangements

14. The part of the community of Maesycwmmmer shown hatched on Map H—

- (a) is transferred to the community of Pengam;
- (b) forms part of the Pengam ward; and
- (c) forms part of the electoral division of Pengam.

15. The part of the community of Pengam shown cross hatched on Map H—

- (a) is transferred to the community of Maesycwmmmer;
- (b) forms part of the Maesycwmmmer ward; and
- (c) forms part of the electoral division of Maesycwmmmer.

Maesycwmmmer and Pontllanfraith – change in community areas and consequential changes to electoral arrangements

16. The part of the community of Maesycwmmmer shown hatched on Map I—

- (a) is transferred to the community of Pontllanfraith;
- (b) forms part of the Pontllanfraith ward; and
- (c) forms part of the electoral division of Pontllanfraith.

17. The part of the community of Pontllanfraith shown cross hatched on Map I—

- (a) is transferred to the community of Maesycwmmmer;
- (b) forms part of the Maesycwmmmer ward; and
- (c) forms part of the electoral division of Maesycwmmmer.

Pengam and Cefn Fforest – change in community areas and consequential changes to electoral arrangements

18. The parts of the community of Pengam shown hatched on Map J and Map K—

- (a) are transferred to the community of Cefn Fforest;
- (b) form part of the Cefn Fforest ward; and

- (c) form part of the electoral division of Cefn Fforest.

Risca – abolition of existing community area to create two new community areas

19.—(1) The existing community of Risca is abolished and the area is divided to form two new communities of Risca East and Risca West as shown on Map L and Map M.

- (2) The new community of Risca East forms part of the electoral division of Risca East.
- (3) The new community of Risca West forms part of the electoral division of Risca West.

Penmaen and Crumlin – change in community areas and consequential changes to electoral arrangements

20. The part of the community of Crumlin shown hatched on Map N—

- (a) is transferred to the community of Penmaen;
- (b) forms part of the Penmaen ward; and
- (c) forms part of the electoral division of Penmaen.

12 March 2010

Carl Sargeant
Minister for Social Justice and Local
Government, one of the Welsh Ministers

Status: This is the original version (as it was originally made). This item of legislation is currently only available in its original format.

EXPLANATORY NOTE

(This note is not part of the Order)

This Order, made in accordance with section 58(2) of the Local Government Act 1972, gives effect to proposals by the Local Government Boundary Commission for Wales (“the Commission”) which reported in July 2009 on their review of boundaries in the County Borough of Caerphilly. The Commission’s report recommended changes to the community boundaries of Bedwas, Trethomas and Machen, Blackwood, Caerphilly Town, Cefn Fforest, Llanbradach and Pwll-y-Pant, Maesycwmmmer, Pengam, Penmaen, Penyrheol Treceenydd and Energlyn, Pontllanfraith, Risca and Van. This Order gives effect to the Commission’s recommendations without modification.

Prints of maps showing the changed boundaries are deposited and may be inspected during normal office hours at the offices of the County Borough of Caerphilly at Tredomen Business and Technology Centre, Tredomen Business Park, Ystrad Mynach, Hengoed, CF82 7FN, and at the offices of the Welsh Assembly Government at Cathays Park, Cardiff, Local Government Policy Division.

Map A of the County Borough of Caerphilly (Communities) Order 2010

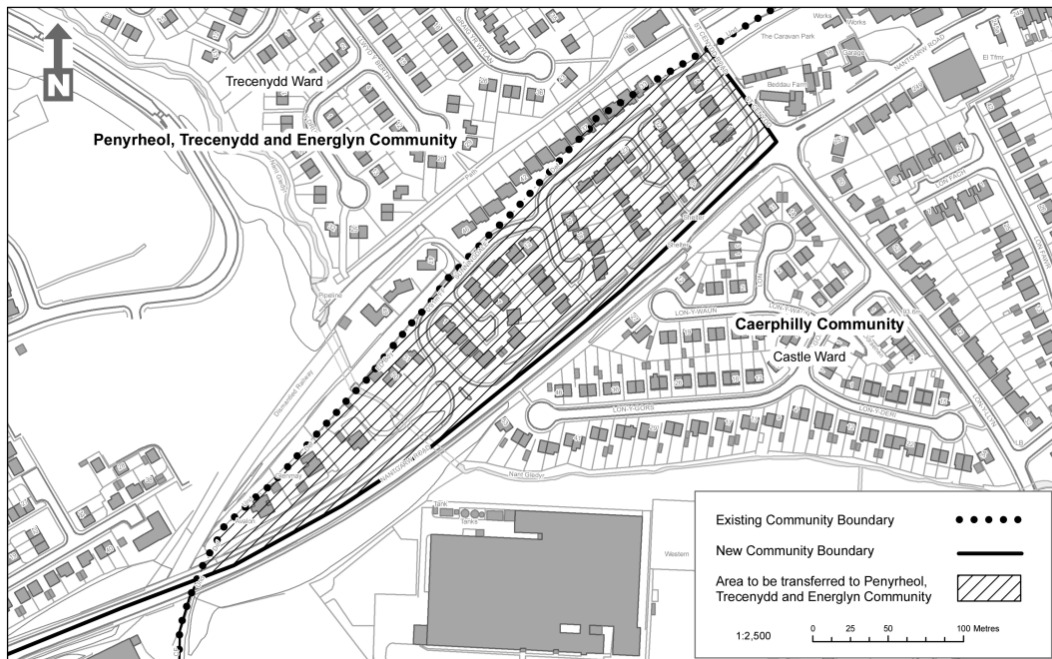

This map is based upon the Ordnance Survey material with the permission of the Ordnance Survey on behalf of The Controller of Her Majesty's Stationery Office. © Crown copyright 2010. Unauthorised reproduction infringes Crown copyright and may lead to prosecution or civil proceedings. Welsh Assembly Government Licence Number: 100017916

229.05-10 Produced by Cartographics, Statistical Directorate, Welsh Assembly Government

Status: This is the original version (as it was originally made). This item of legislation is currently only available in its original format.

Map B of the County Borough of Caerphilly (Communities) Order 2010

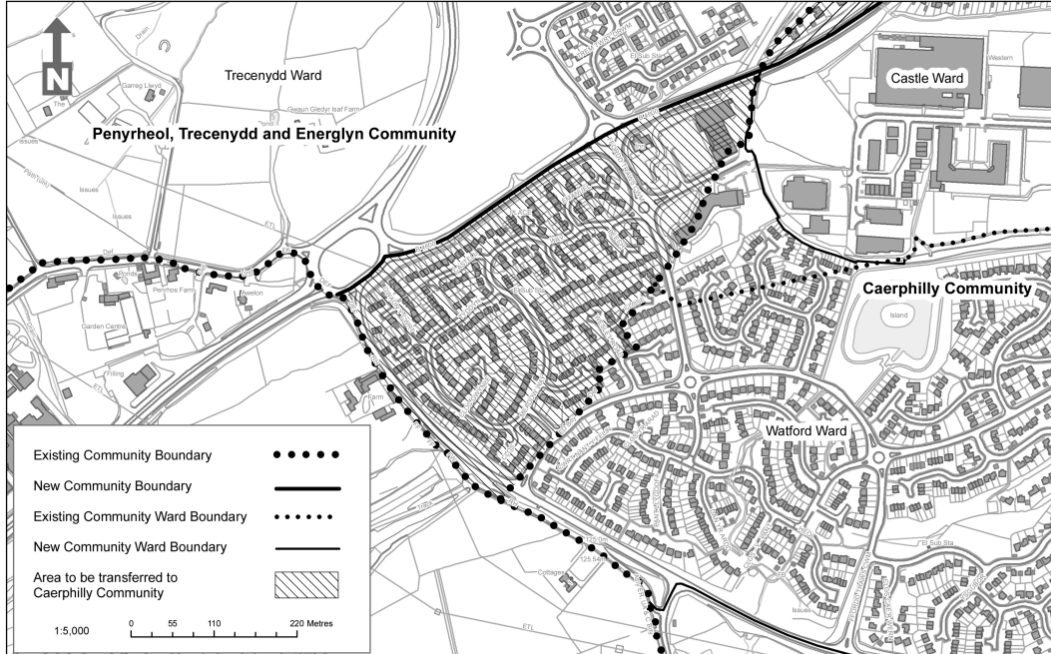

This map is based upon the Ordnance Survey material with the permission of the Ordnance Survey on behalf of The Controller of Her Majesty's Stationery Office. © Crown copyright 2010. Unauthorised reproduction infringes Crown copyright and may lead to prosecution or civil proceedings. Welsh Assembly Government Licence Number: 100017916

229.09-10 Produced by Cartographics, Statistical Directorate, Welsh Assembly Government

Map C of the County Borough of Caerphilly (Communities) Order 2010

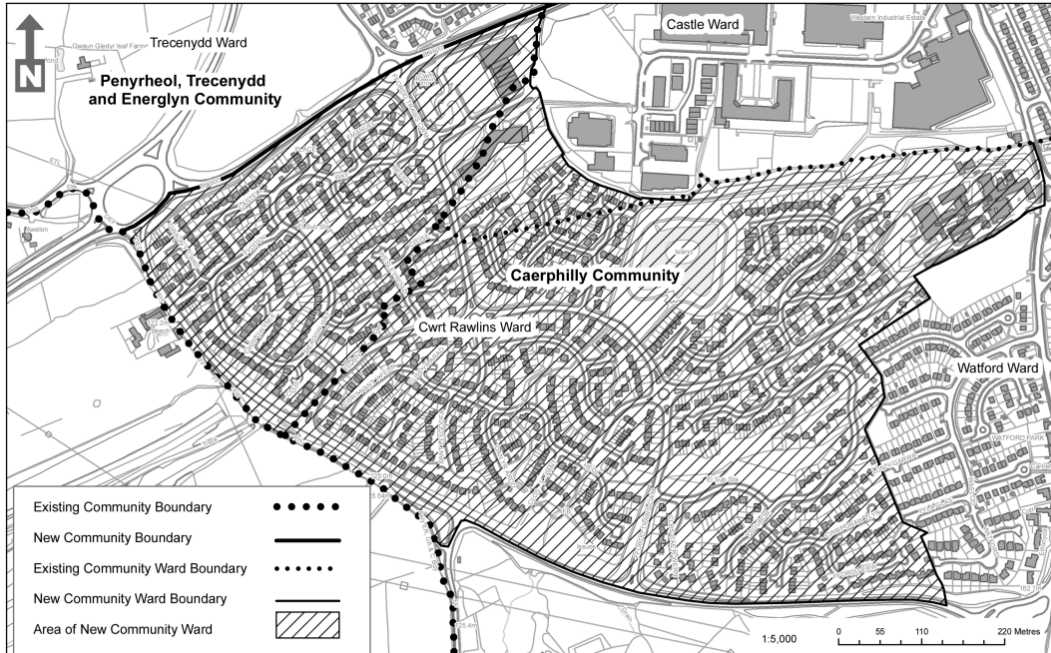

This map is based upon the Ordnance Survey material with the permission of the Ordnance Survey on behalf of The Controller of Her Majesty's Stationery Office. © Crown copyright 2010. Unauthorised reproduction infringes Crown copyright and may lead to prosecution or civil proceedings. Welsh Assembly Government Licence Number: 100017916

229.09-10 Produced by Cartographics, Statistical Directorate, Welsh Assembly Government

Status: This is the original version (as it was originally made). This item of legislation is currently only available in its original format.

Map D of the County Borough of Caerphilly (Communities) Order 2010

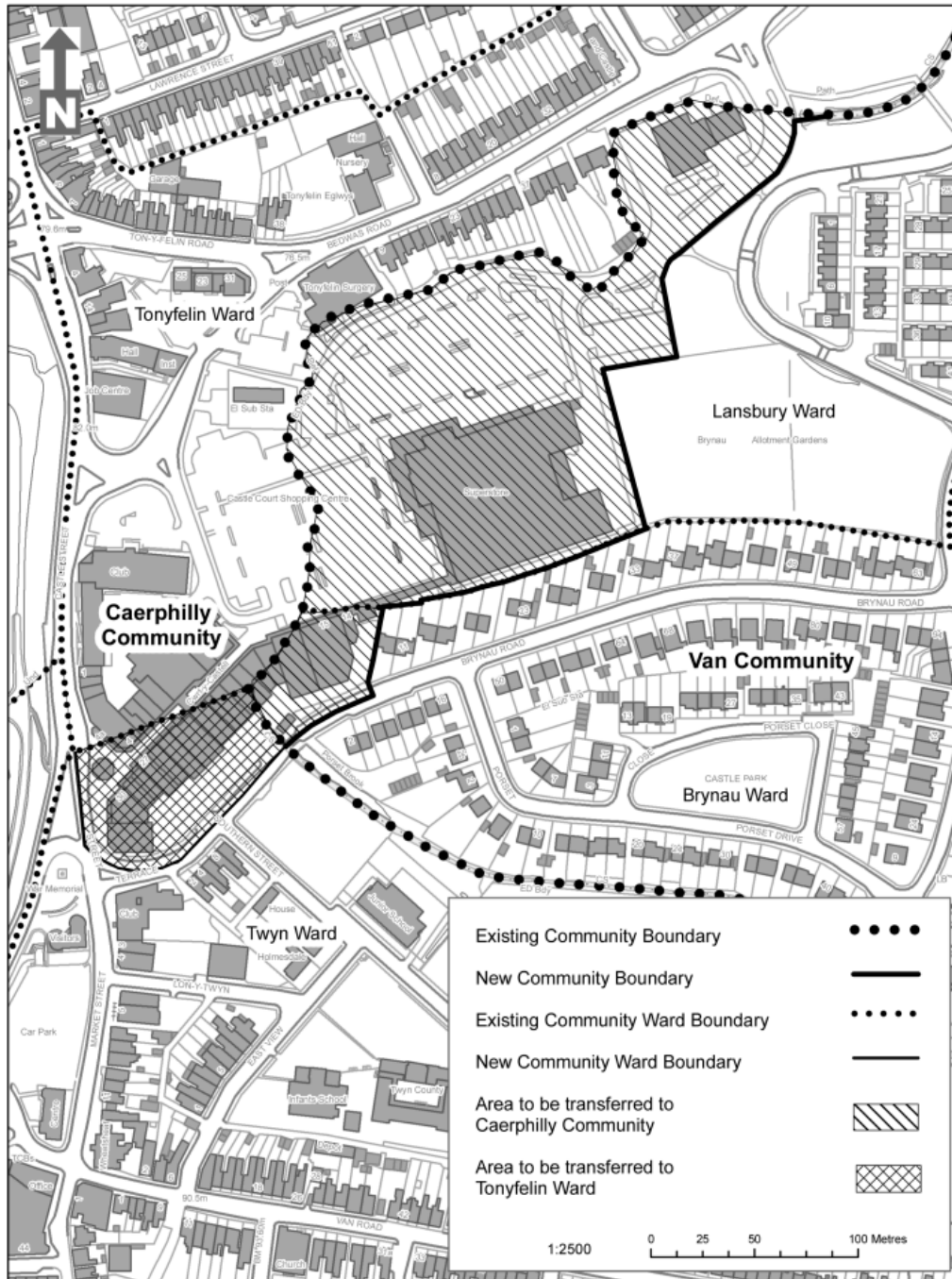

This map is based upon the Ordnance Survey material with the permission of the Ordnance Survey on behalf of The Controller of Her Majesty's Stationery Office. © Crown copyright 2010. Unauthorised reproduction infringes Crown copyright and may lead to prosecution or civil proceedings. Welsh Assembly Government. Licence Number: 100017916

229.09-10 Produced by Cartographics, Statistical Directorate, Welsh Assembly Government

Status: This is the original version (as it was originally made). This item of legislation is currently only available in its original format.

Map E of the County Borough of Caerphilly (Communities) Order 2010

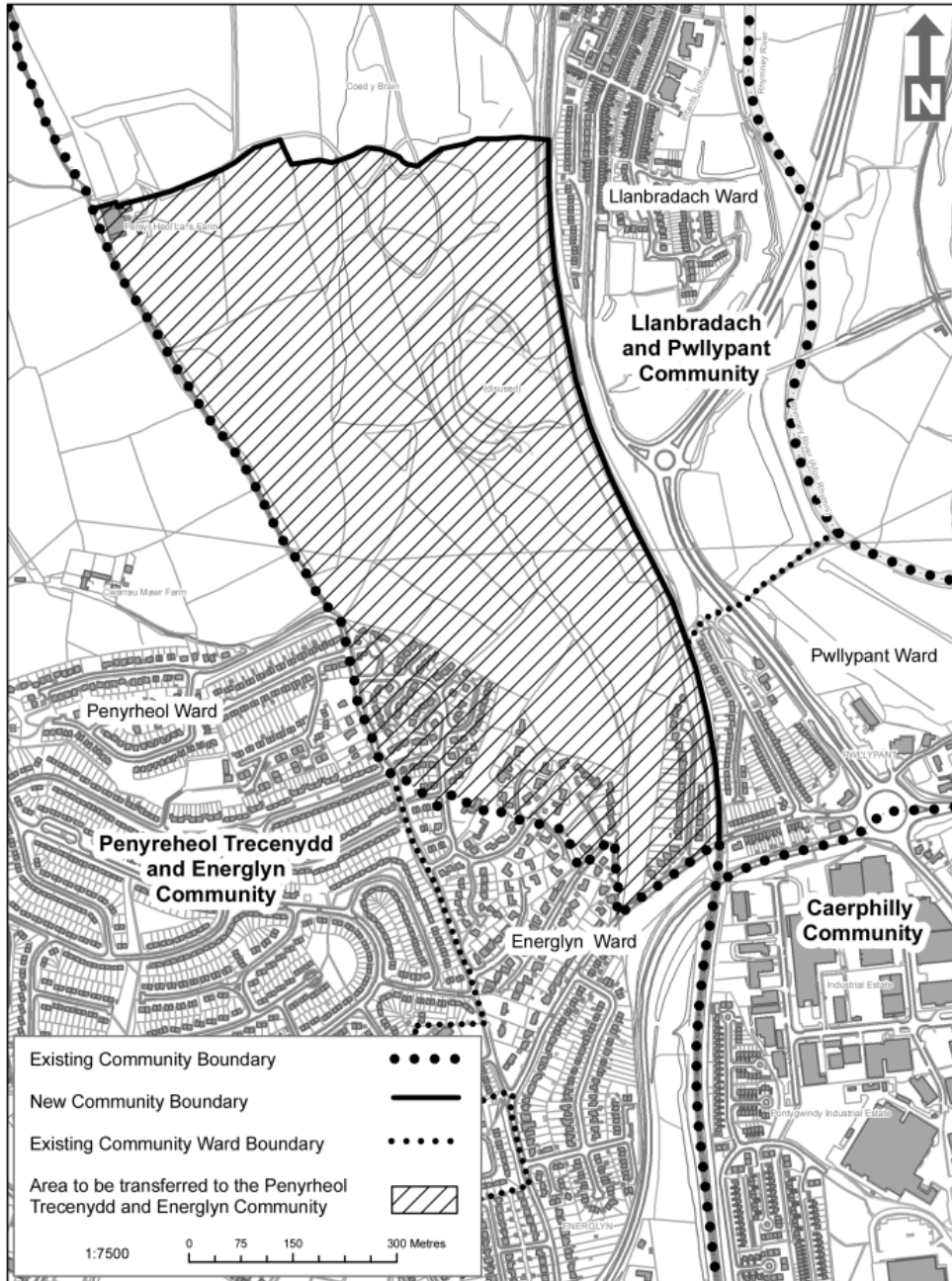

This map is based upon the Ordnance Survey material with the permission of the Ordnance Survey on behalf of The Controller of Her Majesty's Stationery Office, © Crown copyright 2010. Unauthorised reproduction infringes Crown copyright and may lead to prosecution or civil proceedings. Welsh Assembly Government. Licence Number: 100017916

229.09-10 Produced by Cartographics, Statistical Directorate, Welsh Assembly Government

Status: This is the original version (as it was originally made). This item of legislation is currently only available in its original format.

Map F of the County Borough of Caerphilly (Communities) Order 2010

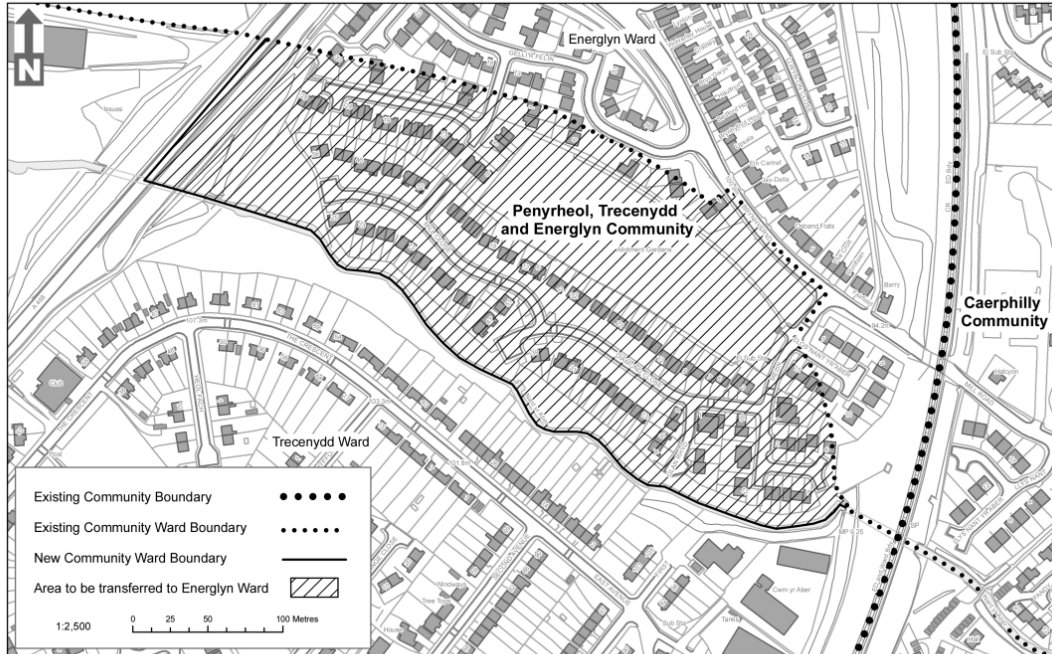

This map is based upon the Ordnance Survey material with the permission of the Ordnance Survey on behalf of The Controller of Her Majesty's Stationery Office. © Crown copyright 2010. Unauthorised reproduction infringes Crown copyright and may lead to prosecution or civil proceedings. Welsh Assembly Government Licence Number: 100017916

229.09-10 Produced by Cartographics, Statistical Directorate, Welsh Assembly Government

Map G of the County Borough of Caerphilly (Communities) Order 2010

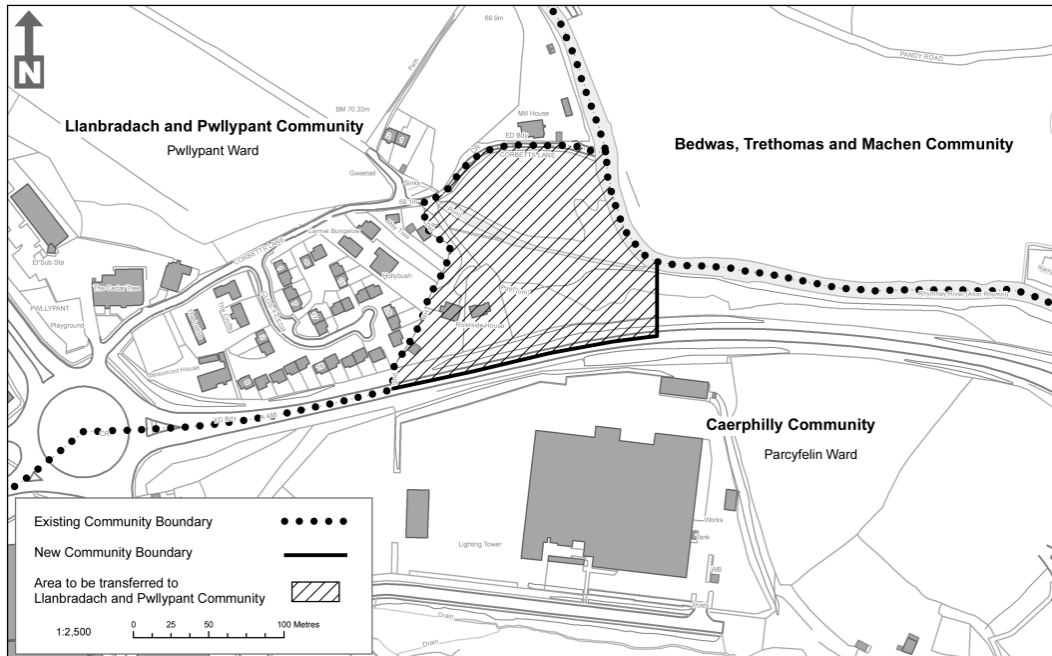

This map is based upon the Ordnance Survey material with the permission of the Ordnance Survey on behalf of The Controller of Her Majesty's Stationery Office. © Crown copyright 2010. Unauthorised reproduction infringes Crown copyright and may lead to prosecution or civil proceedings. Welsh Assembly Government Licence Number: 100017916

229.09-10 Produced by Cartographics, Statistical Directorate, Welsh Assembly Government

Status: This is the original version (as it was originally made). This item of legislation is currently only available in its original format.

Map H of the County Borough of Caerphilly (Communities) Order 2010

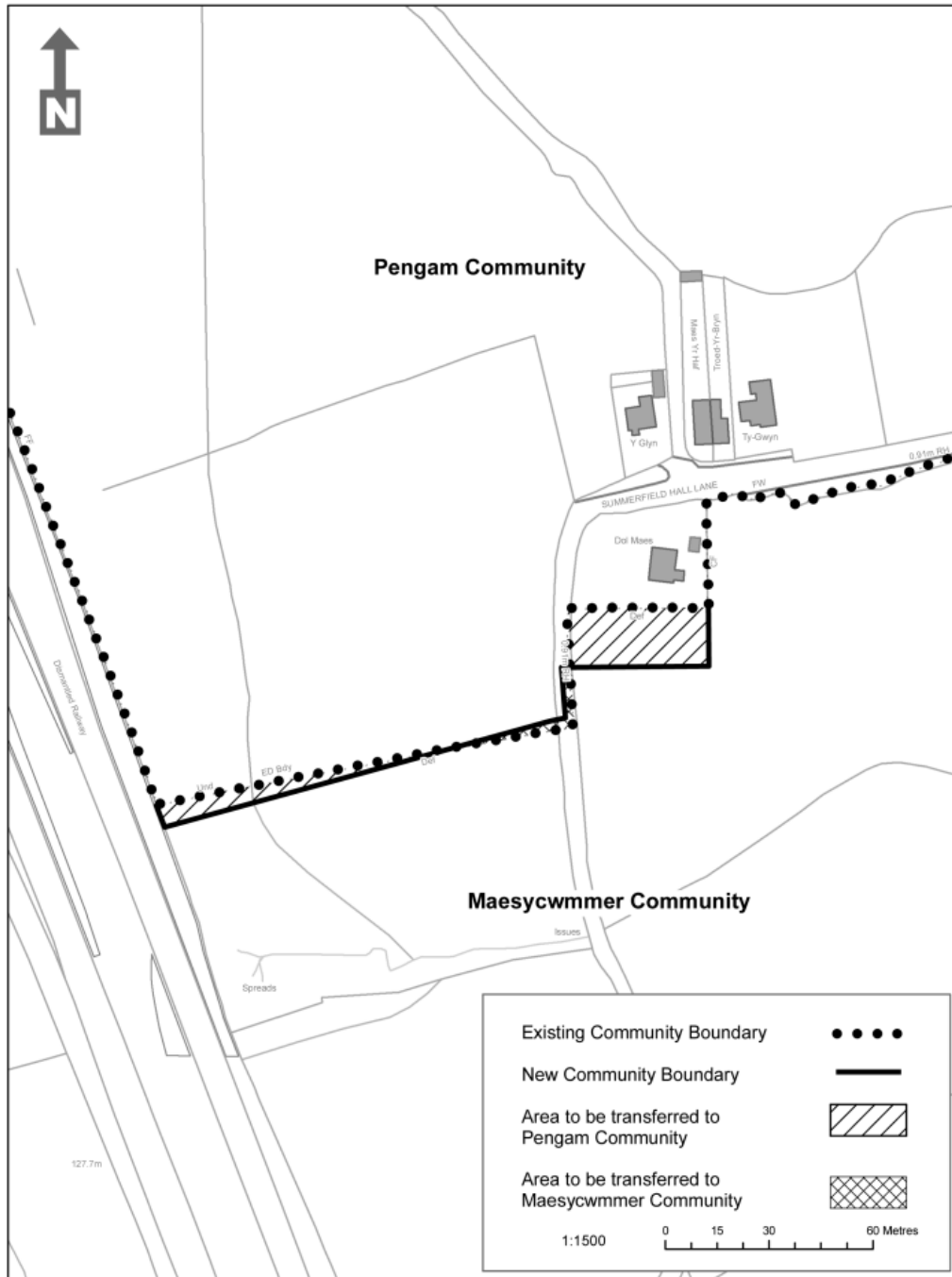

This map is based upon the Ordnance Survey material with the permission of the Ordnance Survey on behalf of The Controller of Her Majesty's Stationery Office, © Crown copyright 2010. Unauthorised reproduction infringes Crown copyright and may lead to prosecution or civil proceedings. Welsh Assembly Government. Licence Number: 100017916

229-09-10 Produced by Cartographics, Statistical Directorate, Welsh Assembly Government

Status: This is the original version (as it was originally made). This item of legislation is currently only available in its original format.

Map I of the County Borough of Caerphilly (Communities) Order 2010

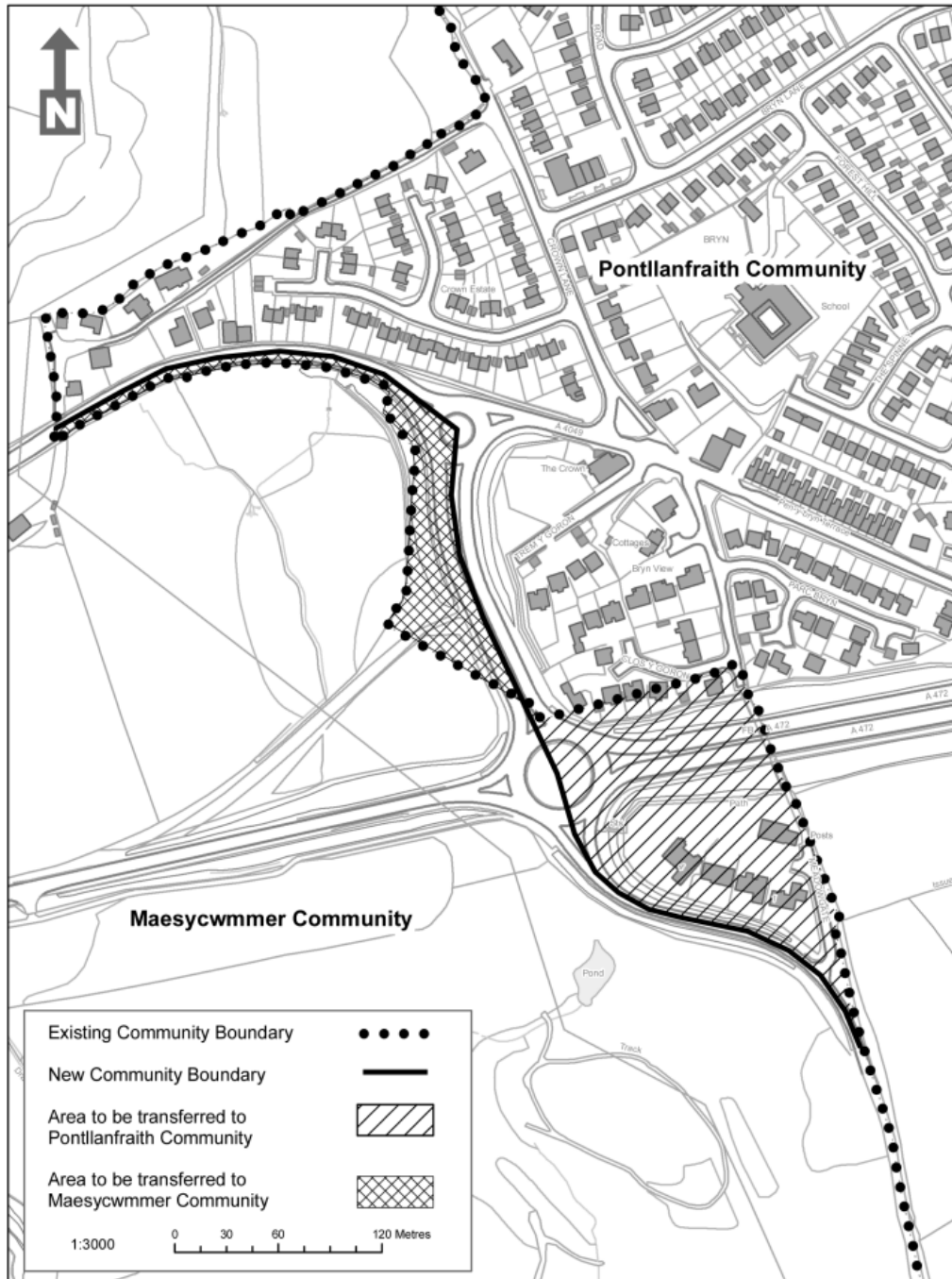

This map is based upon the Ordnance Survey material with the permission of the Ordnance Survey on behalf of The Controller of Her Majesty's Stationery Office, © Crown copyright 2010. Unauthorised reproduction infringes Crown copyright and may lead to prosecution or civil proceedings. Welsh Assembly Government. Licence Number: 100017916

229.09-10 Produced by Cartographics, Statistical Directorate, Welsh Assembly Government

Status: This is the original version (as it was originally made). This item of legislation is currently only available in its original format.

Map J of the County Borough of Caerphilly (Communities) Order 2010

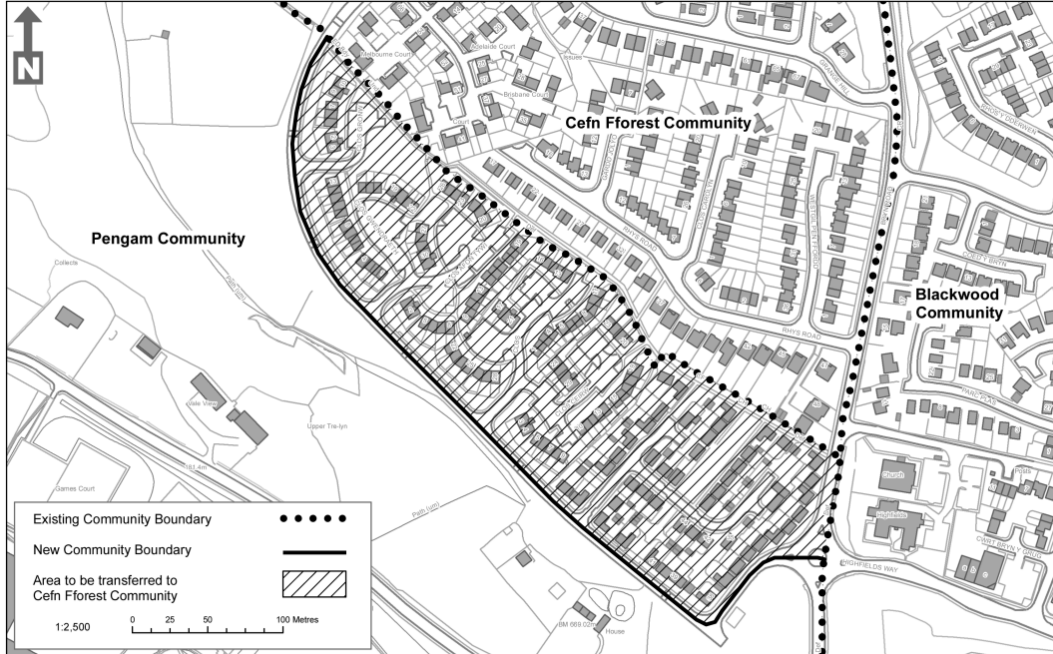

Status: This is the original version (as it was originally made). This item of legislation is currently only available in its original format.

Map K of the County Borough of Caerphilly (Communities) Order 2010

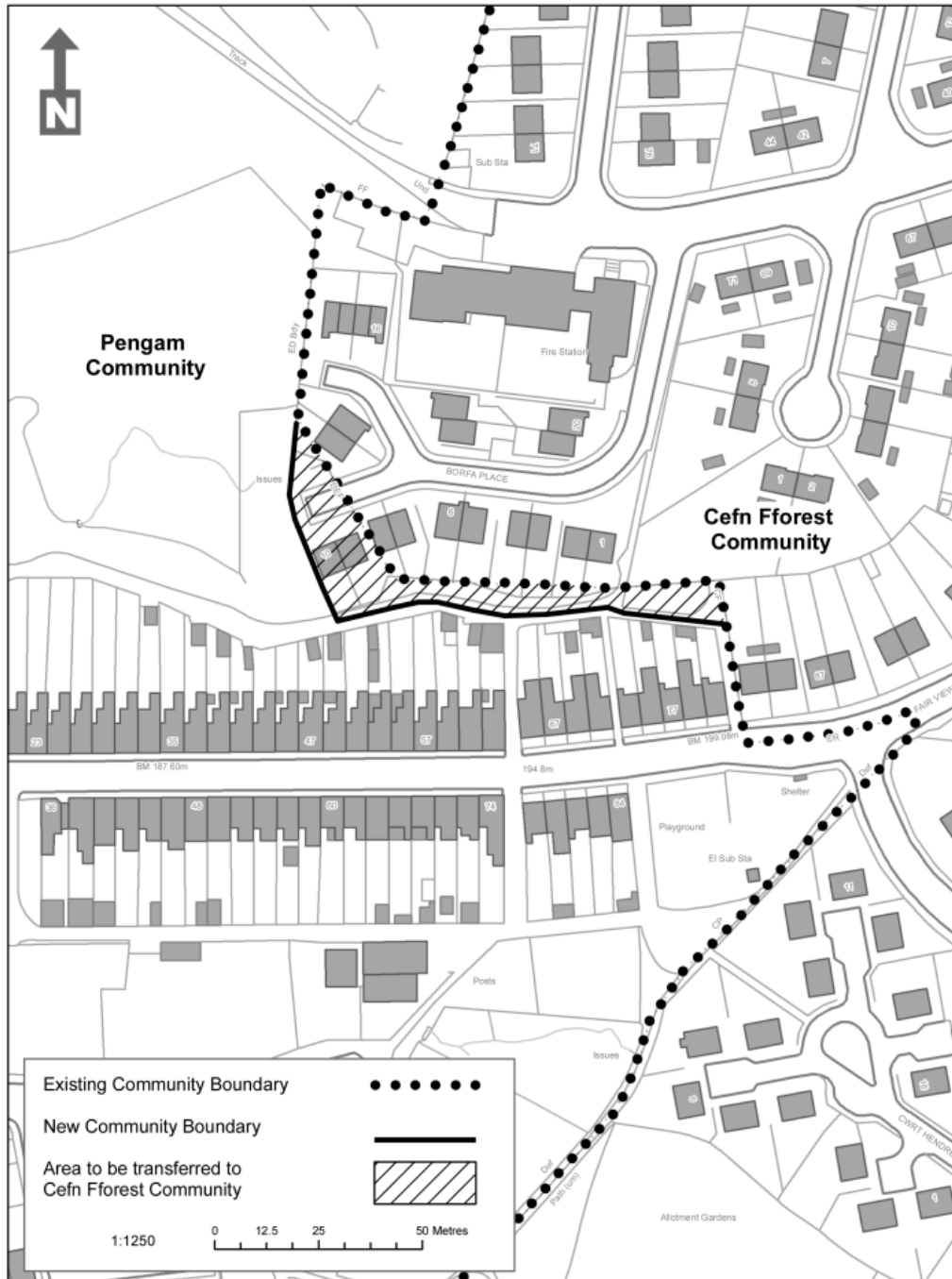

This map is based upon the Ordnance Survey material with the permission of the Ordnance Survey on behalf of The Controller of Her Majesty's Stationery Office, © Crown copyright 2010. Unauthorised reproduction infringes Crown copyright and may lead to prosecution or civil proceedings. Welsh Assembly Government. Licence Number: 100017916

229.09-10 Produced by Cartographics, Statistical Directorate, Welsh Assembly Government

Status: This is the original version (as it was originally made). This item of legislation is currently only available in its original format.

Map L of the County Borough of Caerphilly (Communities) Order 2010

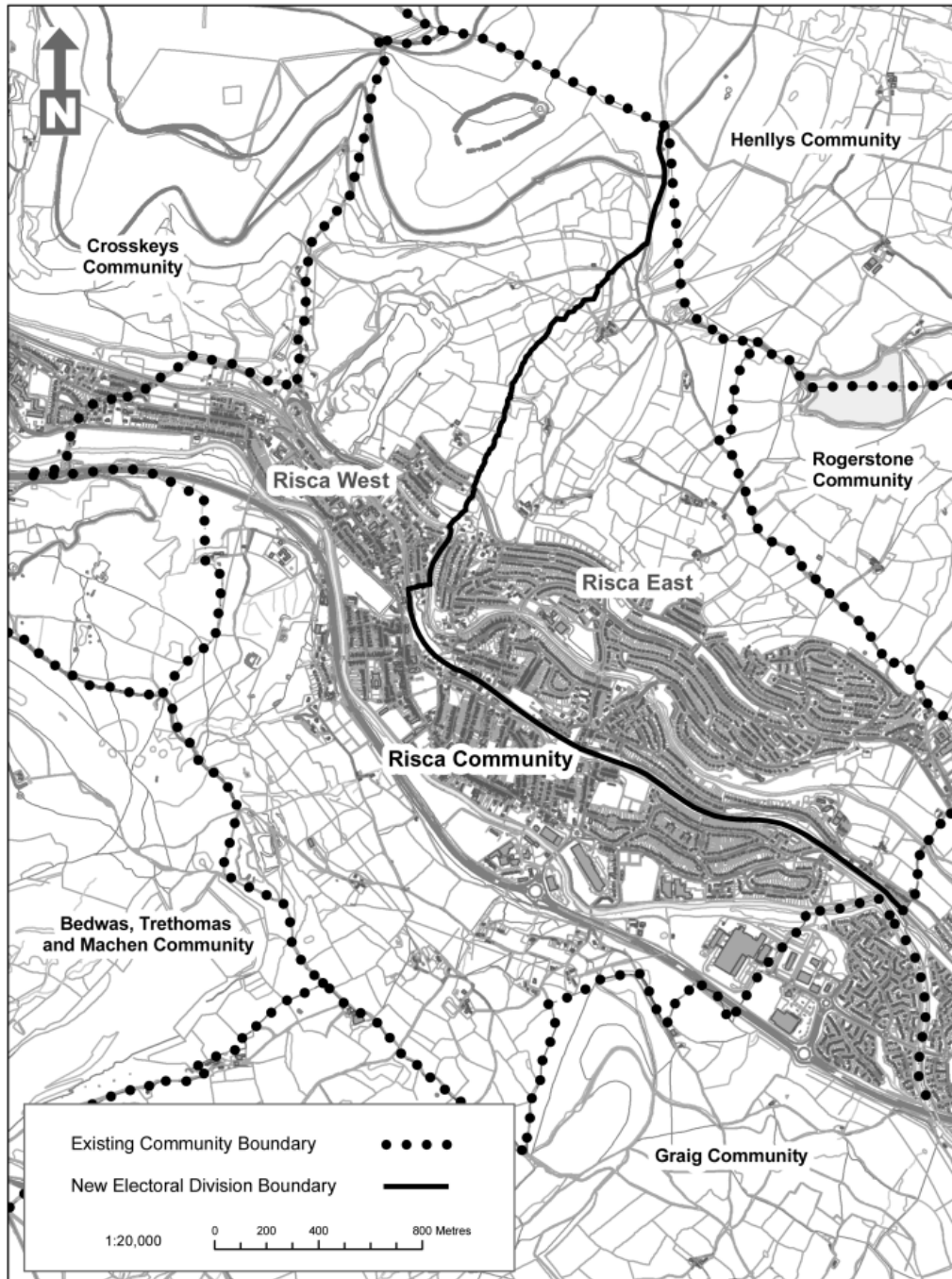

This map is based upon the Ordnance Survey material with the permission of the Ordnance Survey on behalf of The Controller of Her Majesty's Stationery Office. © Crown copyright 2010. Unauthorised reproduction infringes Crown copyright and may lead to prosecution or civil proceedings. Welsh Assembly Government. Licence Number: 100017916

229.09-10 Produced by Cartographics, Statistical Directorate, Welsh Assembly Government

Status: This is the original version (as it was originally made). This item of legislation is currently only available in its original format.

Map M of the County Borough of Caerphilly (Communities) Order 2010

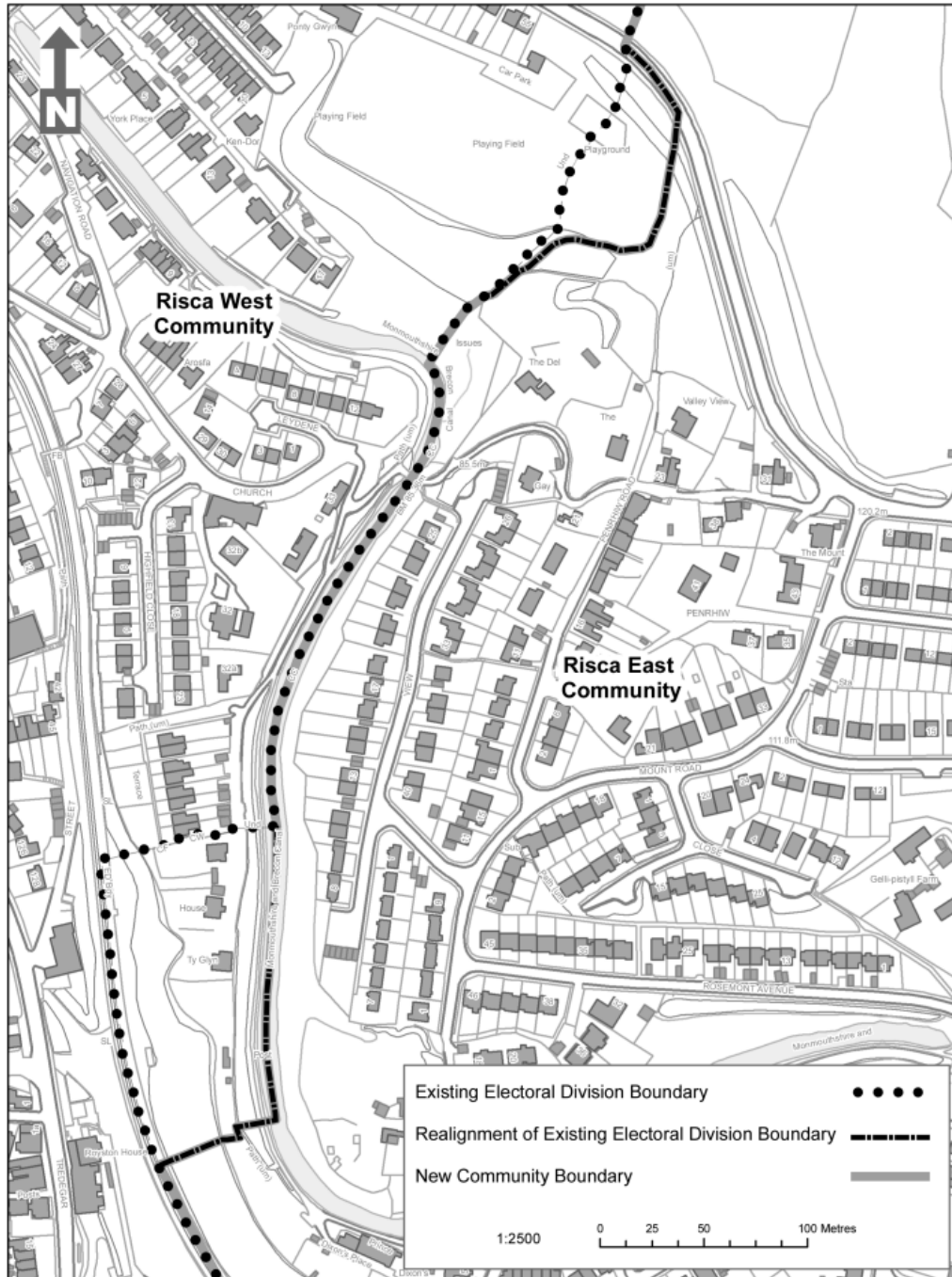

This map is based upon the Ordnance Survey material with the permission of the Ordnance Survey on behalf of The Controller of Her Majesty's Stationery Office, © Crown copyright 2010. Unauthorised reproduction infringes Crown copyright and may lead to prosecution or civil proceedings. Welsh Assembly Government. Licence Number: 100017916

229.09-10 Produced by Cartographics, Statistical Directorate, Welsh Assembly Government

Status: This is the original version (as it was originally made). This item of legislation is currently only available in its original format.

Map N of the County Borough of Caerphilly (Communities) Order 2010

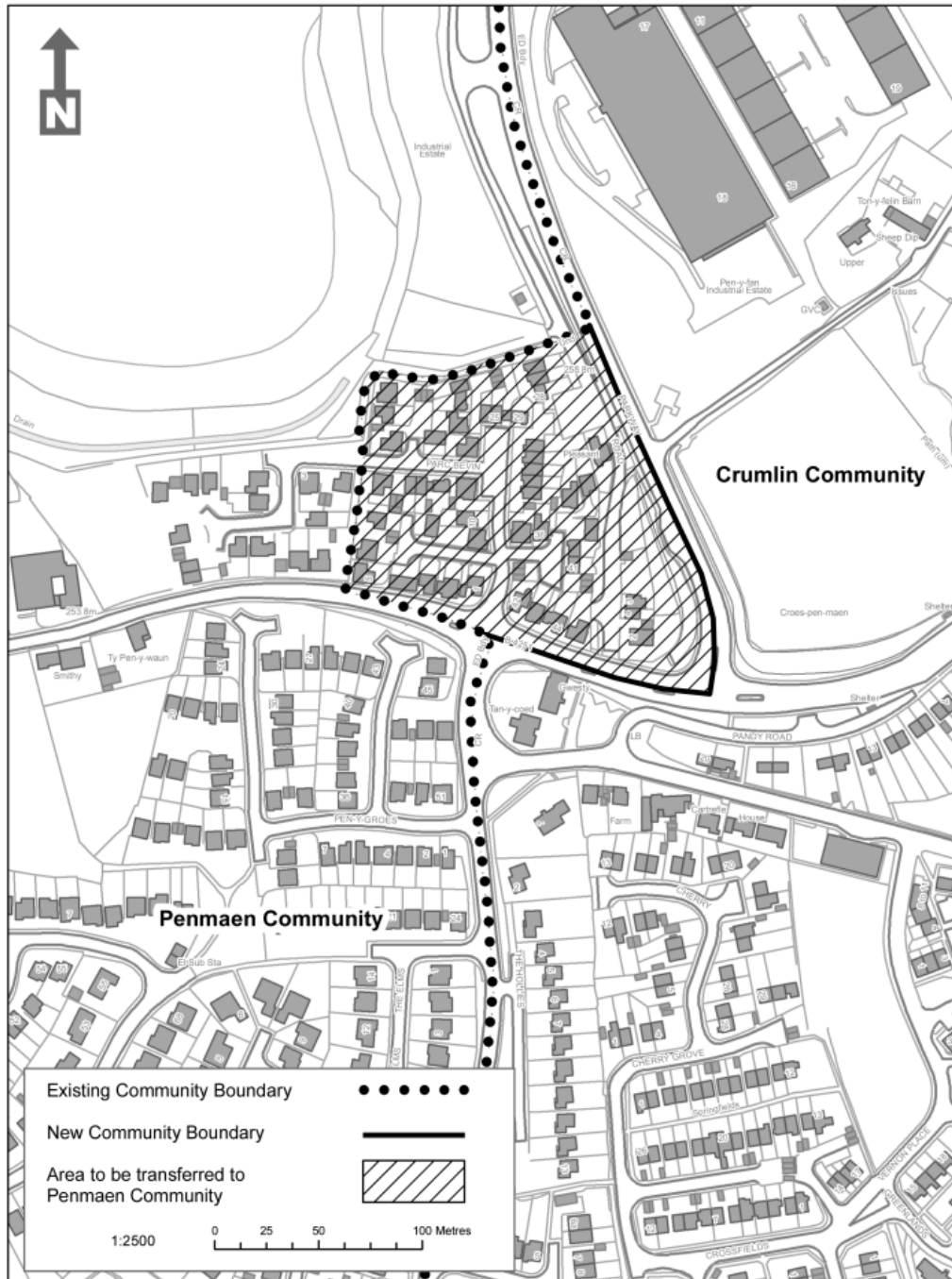

This map is based upon the Ordnance Survey material with the permission of the Ordnance Survey on behalf of The Controller of Her Majesty's Stationery Office, © Crown copyright 2010. Unauthorised reproduction infringes Crown copyright and may lead to prosecution or civil proceedings. Welsh Assembly Government. Licence Number: 100017916

229.09-10 Produced by Cartographics, Statistical Directorate, Welsh Assembly Government